

Initial projector value SOP

1. Turn on Projector
2. Press [Power] + [Down] simultaneously

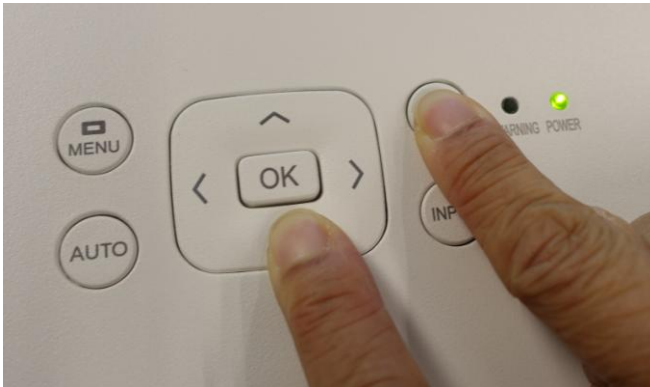

3. Keep press [power + down] button until Warning/Power LED in steady light



4. The screen will display "EEPROM Initialize done..."

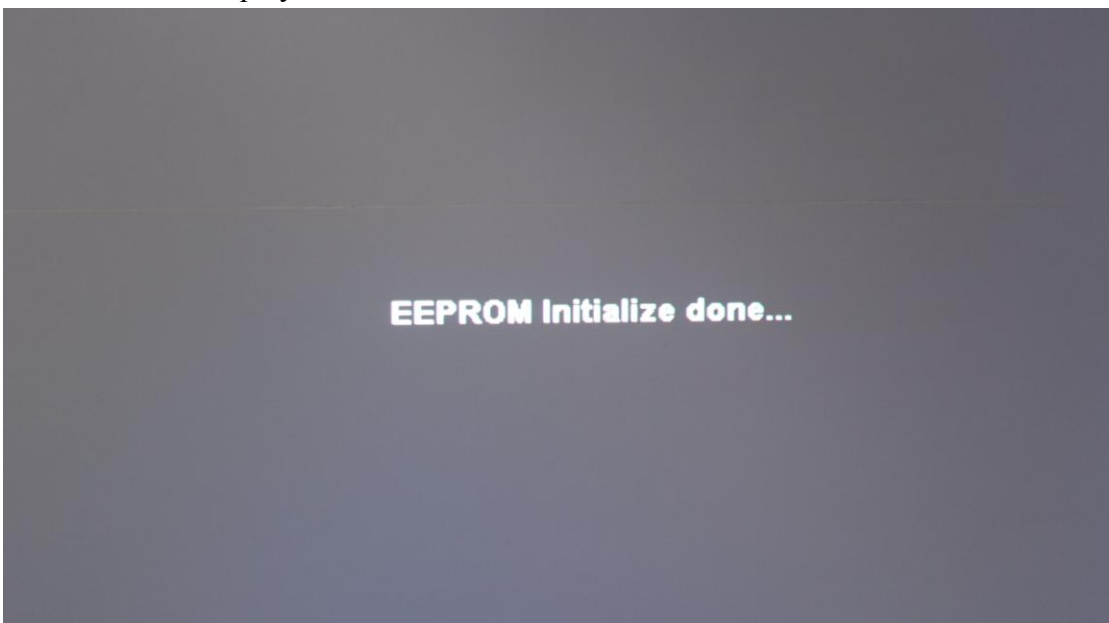

5. Please wait to Power LED in steady light Green
6. Press [Menu]+[Down] simultaneously



7. Press [Menu] to select "Group" and Press [Up] or [Down] to select Group "200".
Press [Menu] to select "No." and Press [Up] or [Down] to select No. "0".
Press [Menu] to select "Data" and Press [Up] or [Down] to select Data "+1" (For LOGO)

Service mode		EIKI
Input	HDMI 1	
Image	Standard	
Group	No.	Data
200	0	+1
Ver.	2.00	EK-301W

8. Press [Menu] and [Up] and [Down] to select Group 200 No.60 Data to "+1". (For Language)

Service mode		EIKI
Input	VGA 1	
Image	Standard	
Group	No.	Data
200	60	+1
Ver.	2.00	RU531X

9. Press [Power] once to close Service menu.

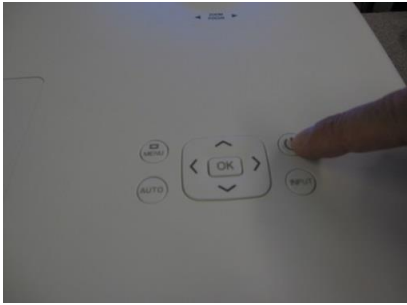

10. Implement "Factory default" in the OSD menu.

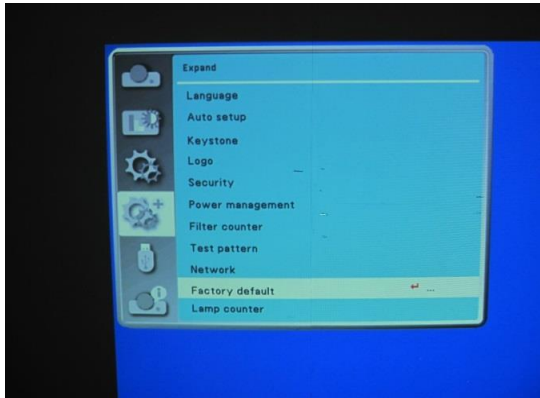

If the Language is Chinese, OSD is as below..

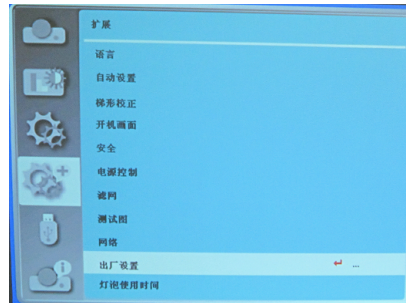

Press [Up] and [Enter] to select "Yes" twice.

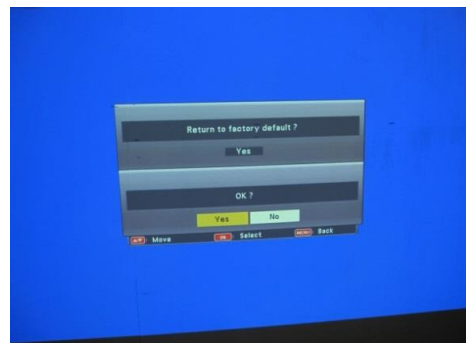
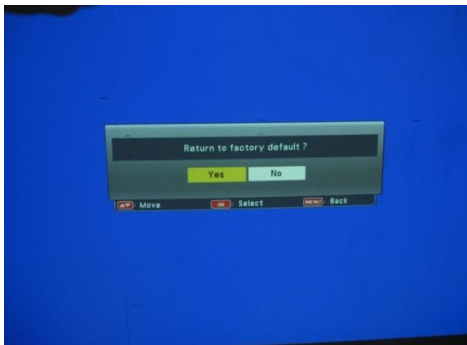

Press [Enter] to start "Factory default"

11. Press [Menu] and [Right] simultaneously more than 5 seconds to show Service menu for FW version.

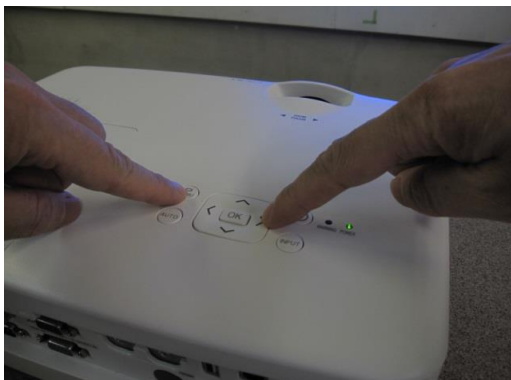

12. Please check the FW version. (ex. V 2.00 1021)

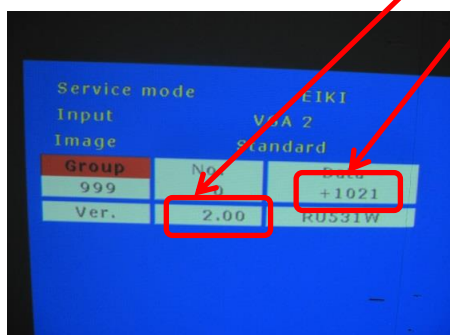

13. Press [Power] once to close Service menu for FW version.

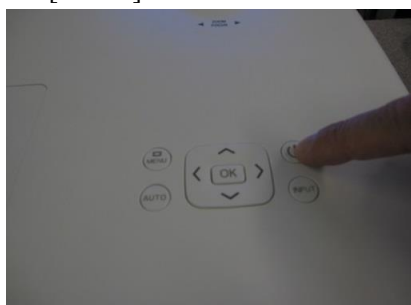

End.